

Setback and Clearance Notes

1 To maintain good air circulation for cooling, please maintain a minimum of 2" from the Stern, Starboard and Port sides to nearest wall.

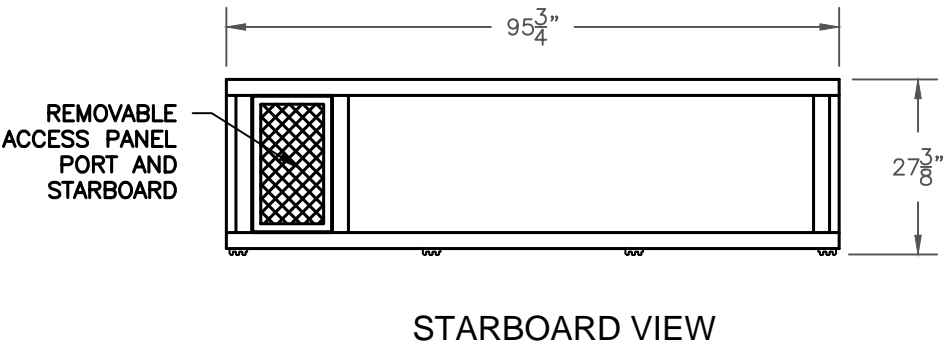
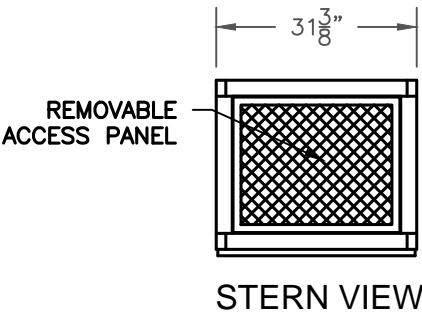
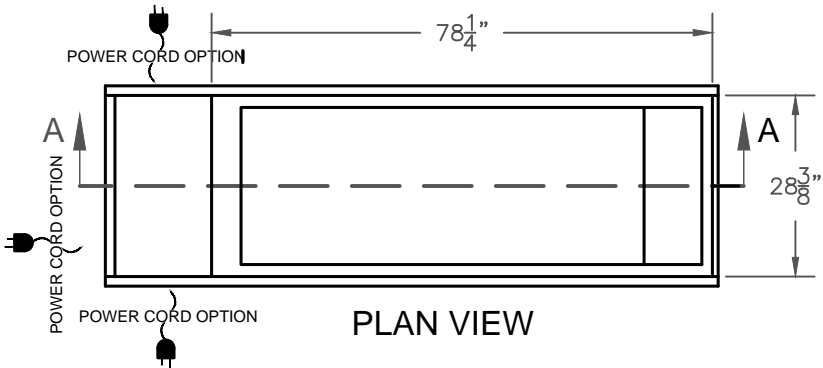
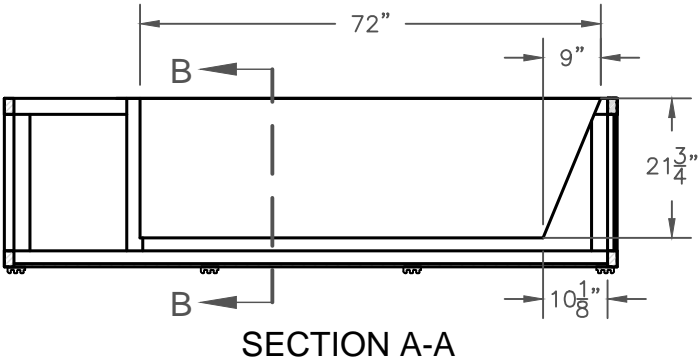
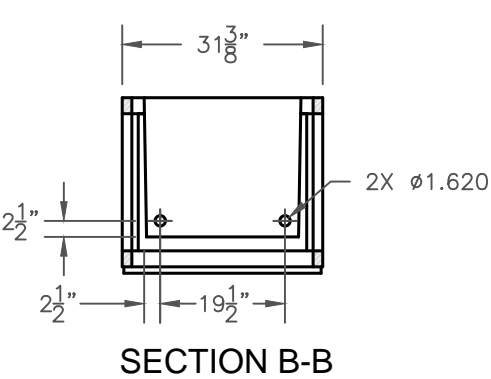
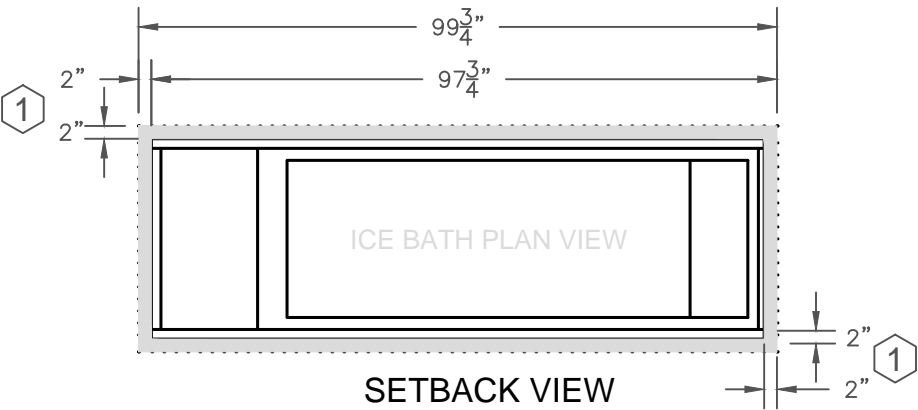

Materials Data

Dry Weight: 370 lbs (Without Lid)
Water Weight: 810 lbs
Wet Weight: 1180 lbs (Without Lid)
Soft Spa Lid: 15 lbs
Premium Wooden Lid: 30 Lbs
Tub: 16GA 304 Stainless Steel
Woodframe: Incense Cedar
Plywood: Aquatek Meranti Fir Water-Proof Marine Plywood
Wood Sealer: Exoshield Tung Oil

Electrical Data

Voltage: 120 volts single phase
Frequency: 60hz
Amps: 12.5 amps
GFCI Trip Current: 4-6mA

Mechanical Data

Compressor Power: 1/3 HP Tecumseh w/Spiral Evap.
Refrigerant: R134a
Plunge Times per Day: 90 min/day
Ambient Operating Temperature: : 15°F - 120°F
Water Temperature: 32°F - 68°F

Water Treatment

Total Water Volume: 97 gal
Disinfection: O₃
Pump: DC50E-24150
Filter: 35sf Cartridge Filter
Ozone Injection Rate: 100mg/hr
Flowrate: 6.2 GPM
Water Turnover Rate: 15 Minutes

DISCLAIMER:

THE MOROZKO IS DESIGNED TO SUPPORT A HEALTHY LIFESTYLE, NOT DIAGNOSE, CURE, OR PREVENT SPECIFIC DISEASES OR MEDICAL CONDITIONS. MOROZKO ICE BATHS ARE NOT MEDICAL DEVICES, AND HAVE NOT BEEN EVALUATED BY THE FDA. MOROZKO MAKES NO CLAIMS OR WARRANTIES WITH REGARD TO THE HEALTH EFFECTS OF COLD PLUNGE THERAPY OR USE OF MOROZKO PRODUCTS. SEEK MEDICAL ADVICE FROM YOUR PHYSICIAN BEFORE EMBARKING ON A PROGRAM OF DELIBERATE COLD EXPOSURE.



Setback and Clearance Notes

1 To maintain good air circulation for cooling, please maintain a minimum of 50.8mm from the Stern, Starboard and Port sides to nearest wall.

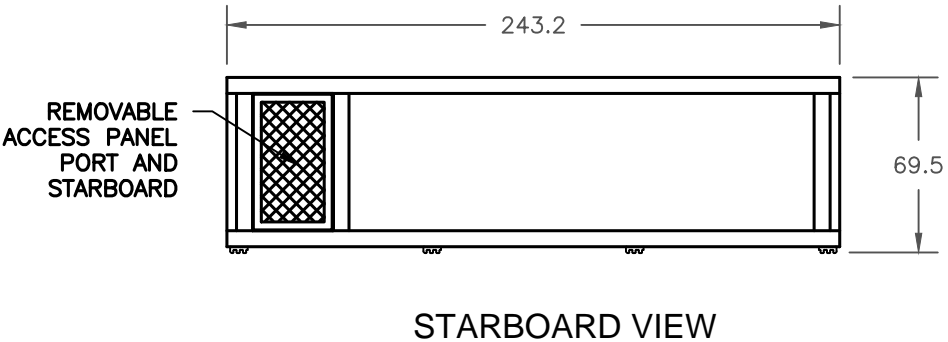
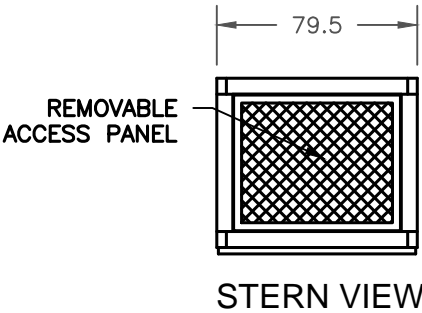
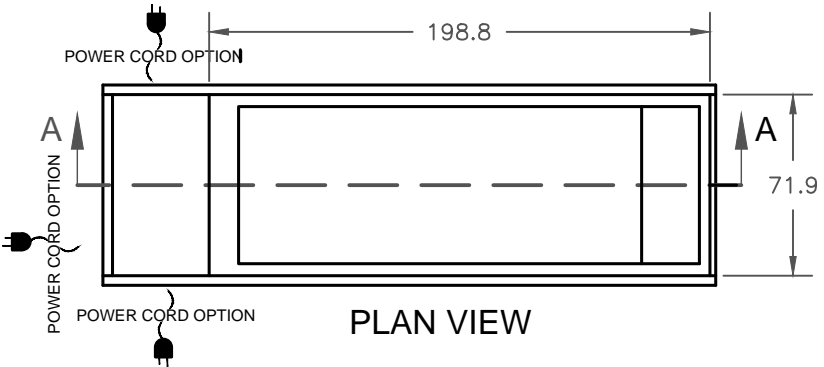
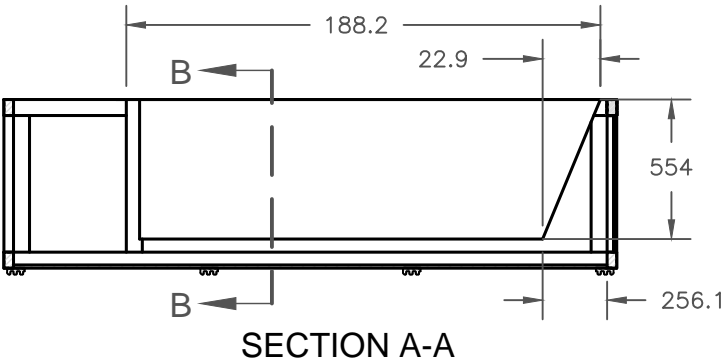
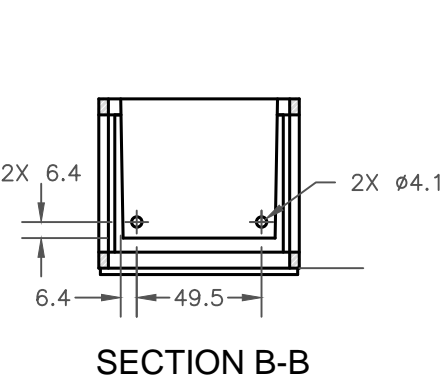
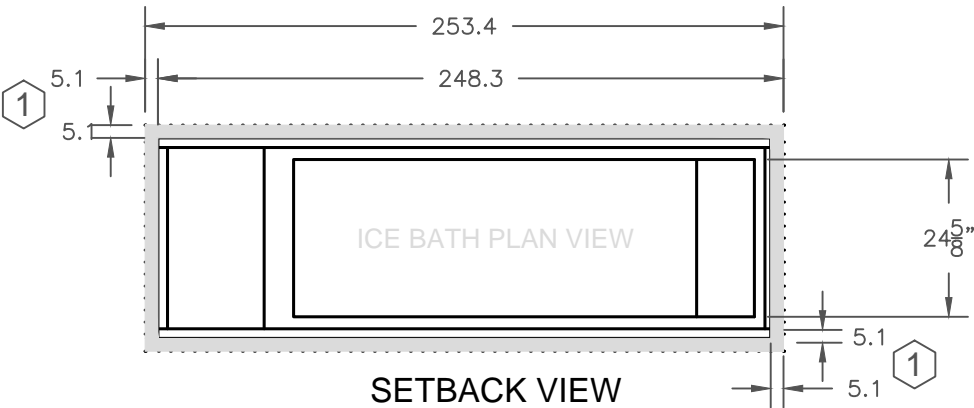

Materials Data

Dry Weight: 132 kg (Without Lid)
Water Weight: 365 kg
Wet Weight: 497 kg (Without Lid)
Soft Spa Lid: 7 kg
Premium Wooden Lid: 14 kg
Tub: 16GA 304 Stainless Steel
Woodframe: Incense Cedar
Plywood: Aquatek Meranti Fir Water-Proof Marine Plywood
Wood Sealer: Exoshield Tung Oil

Electrical Data

Voltage: 220V Single Phase
Frequency: 60hz
Amps: 7 amps
GFCI Trip Current: 4-6mA

Mechanical Data

Compressor Power: 1/3 HP Tecumseh w/Spiral Evap.
Refrigerant: R134a
Plunge Times per Day: 90 min/day
Ambient Operating Temperature: : -10°C - 49°C
Water Temperature: 0°C - 20°C

Water Treatment

Total Water Volume: 368 L
Disinfection: O₃
Pump: DC50E-24150
Filter: 35sf Cartridge Filter
Ozone Injection Rate: 200 mg/hr (dual 100 mg/hr O₃ generator)
Flowrate: 23.47 Liters per Minute
Water Turnover Rate: 15 Minutes

DISCLAIMER:

THE MOROZKO IS DESIGNED TO SUPPORT A HEALTHY LIFESTYLE, NOT DIAGNOSE, CURE, OR PREVENT SPECIFIC DISEASES OR MEDICAL CONDITIONS. MOROZKO ICE BATHS ARE NOT MEDICAL DEVICES, AND HAVE NOT BEEN EVALUATED BY THE FDA. MOROZKO MAKES NO CLAIMS OR WARRANTIES WITH REGARD TO THE HEALTH EFFECTS OF COLD PLUNGE THERAPY OR USE OF MOROZKO PRODUCTS. SEEK MEDICAL ADVICE FROM YOUR PHYSICIAN BEFORE EMBARKING ON A PROGRAM OF DELIBERATE COLD EXPOSURE.